

BATALA

REVISED LAY-OUT PLAN OF INDUSTRIAL FOCAL POINT BATALA

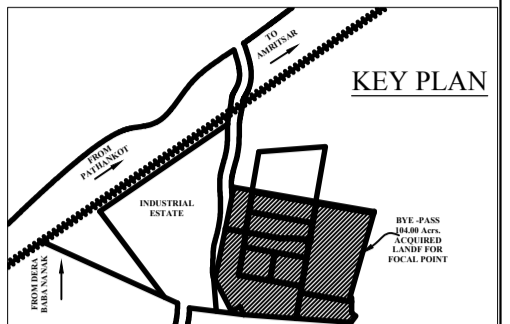

SCHEME DETAIL

TOTAL SCHEME AREA	104.00 Acres
-------------------	--------------

DETAIL OF PLOTS :-

S.NO.	CATEGORY	NO OF PLOTS	AREA
1.	4 Acres & Above	9	5.85 Acres
2.	1 Acres & Above	9	12.50 Acres
3.	1/2 Acres	46	25.18 Acres
4.	1/4 Acres	64	13.08 Acres
5.	500 Sq. Yards	16	1.66 Acres
TOTAL AREA		136	59.28 Acres

LAND ANALYSIS:-

S.NO.	CATEGORY	AREA	% TO THE TOTAL
1.	AREA UNDER PLOTS	64.68 Acres	62.78%
2.	AREA UNDER COMMERCIAL AREA	3.20 Acres	3.07%
3.	AREA UNDER PUBLIC BUILDING	2.22 Acres	2.17%
4.	AREA UNDER OPEN SPACE	12.54 Acres	12.11%
5.	AREA UNDER ROAD	14.80 Acres	14.23%
6.	AREA UNDER WATER WORKS	0.90 Acres	0.87%
7.	AREA UNDER ELECT. SUB-STN.	4.06 Acres	3.90%
8.	AREA UNDER DISPOSAL WORK/CETP	1.26 Acres	1.21%
9.	AREA UNDER RESERVE FOR PUBLIC HEALTH SERVICES	0.32 Acres	0.31%
TOTAL AREA		104.00 Acres	100%

DETAIL OF SALEABLE AREA
 SALEABLE AREA = 70.70 Acres
 PERCENTAGE TO THE TOTAL = 67.63%
 DETAIL OF NUMBERING = 10.10.1978

- NOTE:-**
- SALEABLE AREA INCLUDING AREA UNDER PLOTS PLUS 50% AREA COMMERCIAL USE AND AREA UNDER ELECTRIC SUB-STATION. FOR SET BACK LINES, SITE COVERAGE SEPARATE ZONING PLAN SHALL BE PREPARED SUBSEQUENTLY.
 - SITE FOR WATER WORKS AND DISPOSAL WORKS ARE TENTATIVE. LAY-OUT PLAN HAS BEEN MODIFIED TO EARMARKED THE SITE FOR 66 K.V. ELECTRIC SUB-STATION ON DATE 17.9.1979.
 - LAY-OUT PLAN MODIFIED AS PER SURVEY SUBMITTED BY S.D.E. XE-VI P.S.I.C. MOGA VIDE LETTER NO-2133, DATED 22.11.78.
 - PUMP CHAMBER STAFF QUARTERS AND MAINTENANCE OFFICE HAS BEEN MARKED ON THE PLAN ON DATED-16.2.1979.
 - STANDARD DESIGN FOR STAFF QUARTERS SHALL BE AS PER THIS OFFICE DRG. NO STD/STAFF QUARTERS/1-76.
 - STANDARD DESIGN FOR P.H. FOR CHLORINATION CHAMBER AND TUBE WELL SHALL BE FOLLOWED.
 - FOR THE ARCHITECTURAL DETAILS OF MAINTENANCE OFFICE REFER DRG. NO. MISC/OFFICE-3/78, DATED 21.7.78.
 - POSITION OF O.S.H.R. AND TUBE WELL IS MARKED AS PER DRAWING SUPPLIED BY S.D.E.-IV/ P.S.I.C. VIDE HIS LETTER NO. S.D.E/4577, DATED 5.7.79.
 - ON ACCOUNT OF SAMADHI ON PLOT NO. 79, THE LAY-OUT PLAN HAS BEEN MODIFIED TO CONVERT THE SAME INTO GREEN BELT ON DATED-5.9.80.
 - AS DISCUSSED WITH MANAGING DIRECTOR AND CHIEF ENGINEER, THE BIGGER PLOT NO. 1,2&3 MEASURING AROUND 22.50 ACRES HAS BEEN CONVERTED INTO SMALLER PLOT NO 95TO124, DATED OF AMENDMENT 29.12.80.
 - SITE FOR COAL INDIA LIMITED HAS BEEN REDUCED FROM 3 ACRES TO 2 ACRES ON THERE REQUEST BUT THERE LETTER NO CIL/CMO/CHD/DUMP/986, DATED 22.6.82, AND AS PER THE ORDER OF MANAGING DIRECTOR / P.S.I.C.
 - PLOT NO 131, 131A, 132, 132A, 133A, 133B, 133C AND 133D (1000 SQ. YARDS) HAS BEEN CARVED OUT IN THE PLACE OF PLOT NO 131 AND 132 (3750 SQ. YARDS) AS PER DECISION OF STANDING COMMITTEE HELD ON 22.9.1997.
 - AS PER DECISION TAKEN IN THE LAY-OUT PLAN APPROVAL COMMITTEE MEETING HELD ON 4.7.2013 APPROVED ROAD FROM BYE-PASS TO FOCAL POINT CARVED OUT IN LAY-OUT PLAN ADJOINING DISPOSAL AREA.

OFFICE OF THE CHIEF ENGINEER
 PUNJAB SMALL INDUSTRIES & EXPORT CORPORATION
 18, HIMALAYAN MARG,
 UDYOG BHAWAN, SECTOR 17-A CHANDIGARH

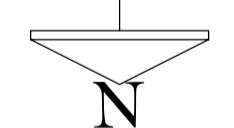

SCALE:- 1"=120'-0"

-s/d-

SUKHDEV SINGH
 DRAWN BY

-s/d-

SUPERINTENDING ENGINEER -

DRAWING PREPARED IN AUTO CAD

THIS DRAWING PREPARED ON THE BASIS OF DRAWING NO-P-223LP-478, DATED - 29.6.74/REV-31.1.79.5.9.80/29.12.80

DILPREET
 TRACED BY (J.D.M)

VIKAS GUPTA
 CHECKED BY (J.D.M)

SUKHDEV SINGH
 PLANNING OFFICER -

J.S. RANDHWA
 GENERAL MANAGER (PLANNING)-

INDUSTRIAL PLOTS AVAILABLE FOR ALLOTMENT SHOWN THUS

NOTE:-

- RESIDENTIAL POCKET ADJOINING PLOT NO. 4 CONVERTED INTO INDUSTRIAL PLOT MEASURING 5.00 ACRES AND RAW MATERIAL DEPOT 2.40 ACRES. AS PER DECISION TAKEN IN LAY-OUT PLAN APPROVAL COMMITTEE MEETING HELD ON 12.6.14.
- PLOT NO-5B HAS BEEN CARVED OUT FROM DEPOT SITE ON 6.2.1984 AFTER MAKING THE DEPOT LAY-OUT.
- AS PER DECISION OF ALLOTMENT COMMITTEE HELD ON 5.5.1995 THE 1000 SQ. YARDS PLOT (125 TO 130, 133TO138) AND 3/4 ACRES PLOT NO (131& 132) HAS BEEN CARVED OUT IN PLACE OF PLOT NO 95 TO 98(ONE ACRES).
- AS PER THE DECISION TAKEN IN THE MEETING OF PLAN APPROVAL COMMITTEE HELD ON 8.7.2014. THE RESIDENTIAL POCKET ADJOINING COMMERCIAL AREA CONVERTED INTO INDUSTRIAL PLOT MEASURING 2.90 ACRES NUMBERED AS 1-B AND RESIDENTIAL POCKET ADJOINING TESTING LAB. ALSO CONVERTED IN THE INDUSTRIAL PLOT MEASURING 1.60 ACRES. NUMBERING AS 1-C.
- DIMENSION OF THE PLOT NO 99 TO 111 HAS BEEN MARKED (AS PER SITE) GIVEN BY XEN.6. VIDE HIS LETTER NO 134/13.8.82.
- AS PER ESTIMATE APPROVAL COMMITTEE MEETING HELD ON 18.12.2002. THE SALE ABLE AREA HAS BEEN INCREASED BY CONVERTING 8 MARLAS TO 10 MARLAS PLOTS.
- THIS DRAWING SUPERSEDED ALL THE PREVIOUS DRAWINGS. DRAWING NO P-22LP-3/78 AND DRAWING NO P-22LP-2/78 DATED-18.1.78.
- AS PER ORDER OF M.D. DATED 30.9.16 PLOT NO. 1-B MEASURING 2.90 ACS. CONVERTED INTO 1000 SQ. YARDS PLOTS NUMBERED AS 139 TO 154.

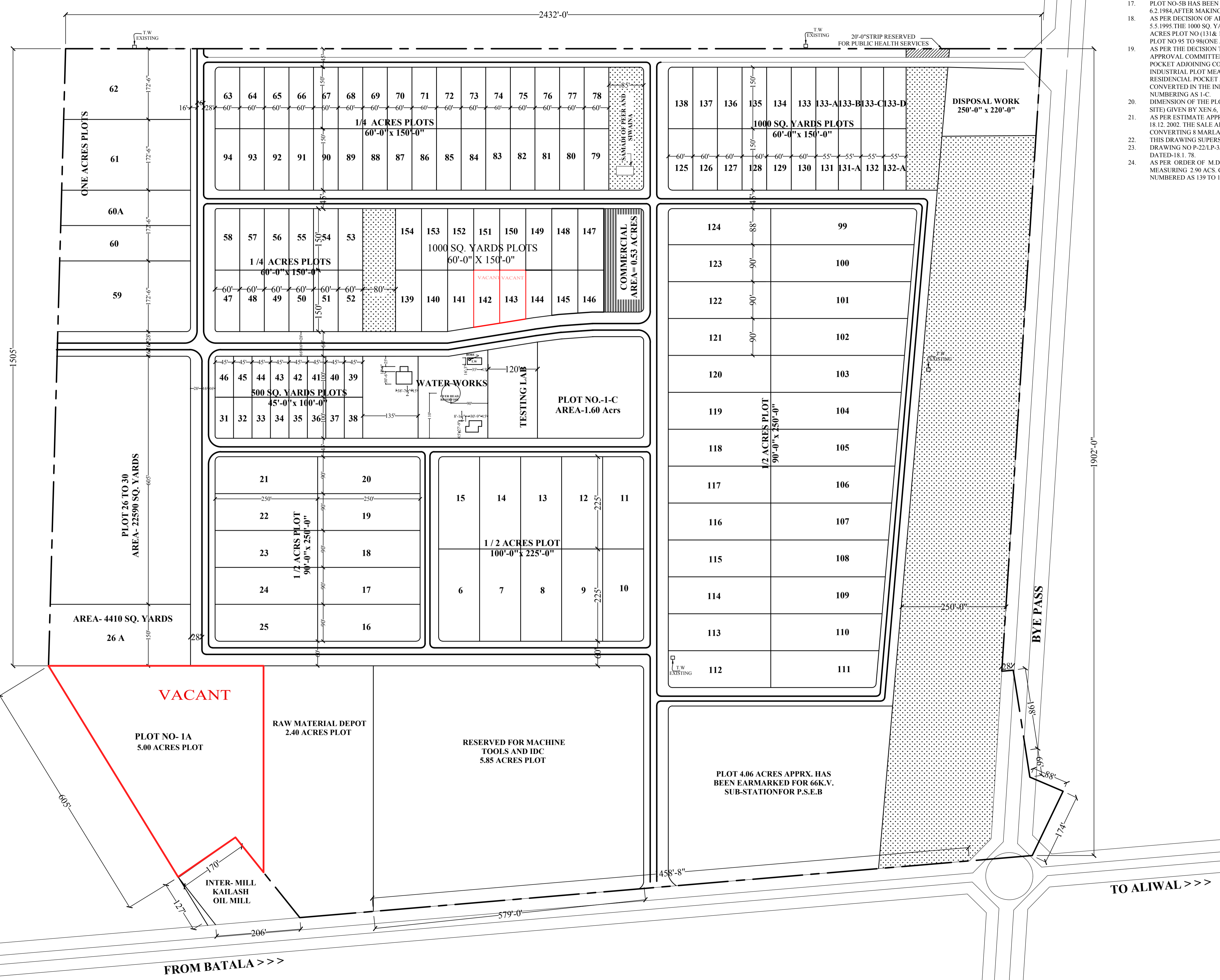

TO ALI WAL >>>

FROM BATALA >>>